

S-AS200

Wearable Assistive Support Quick Start Guide

202508

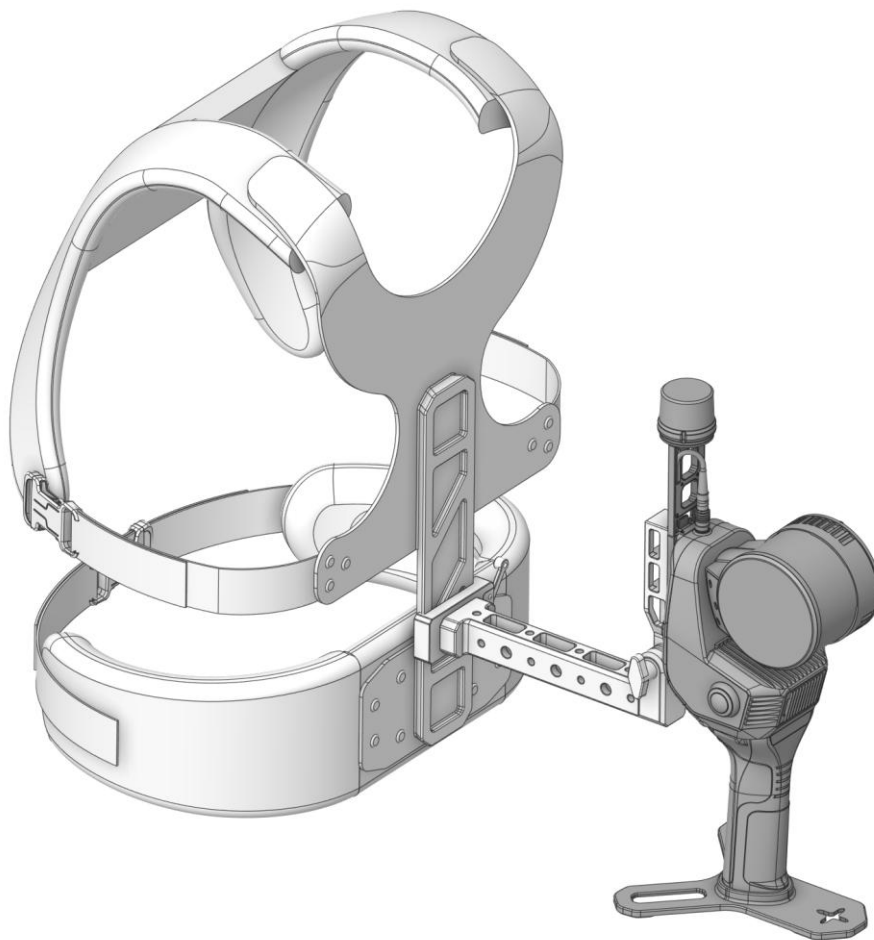

Shenzhen Feima Robotics Co., Ltd.

Supported Scanner Models for S-AS200

SLAM100

SLAM200

SLAM200B

SLAM200E

SLAM2000

Assembly Steps

1

Push the locking switch on the support arm upward to the release position.

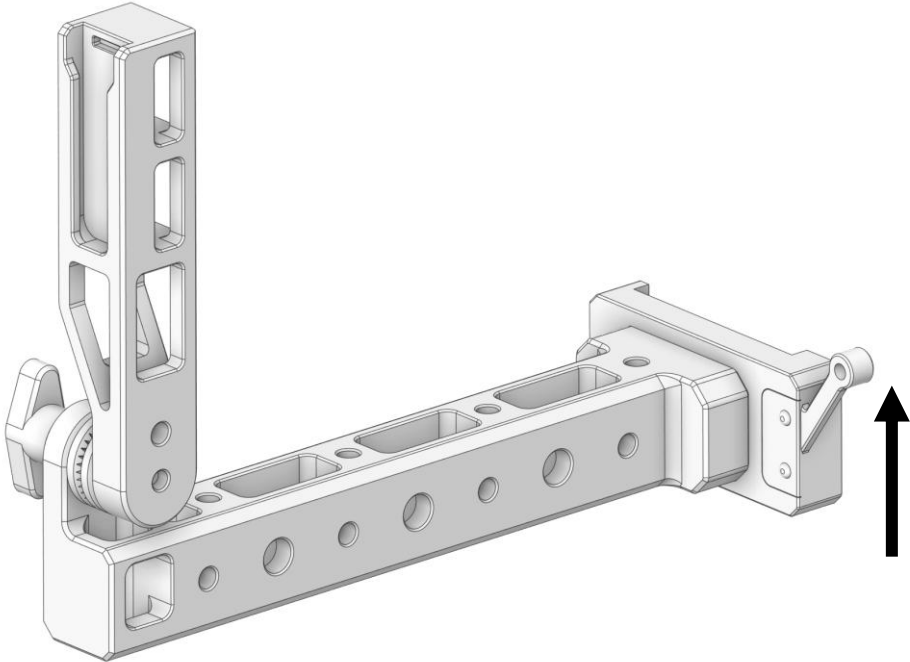

2

Align the groove on the support arm with the front slide rail of the chest support, insert it downward to the desired position, then push the locking switch downward to the lock position to secure the support arm.

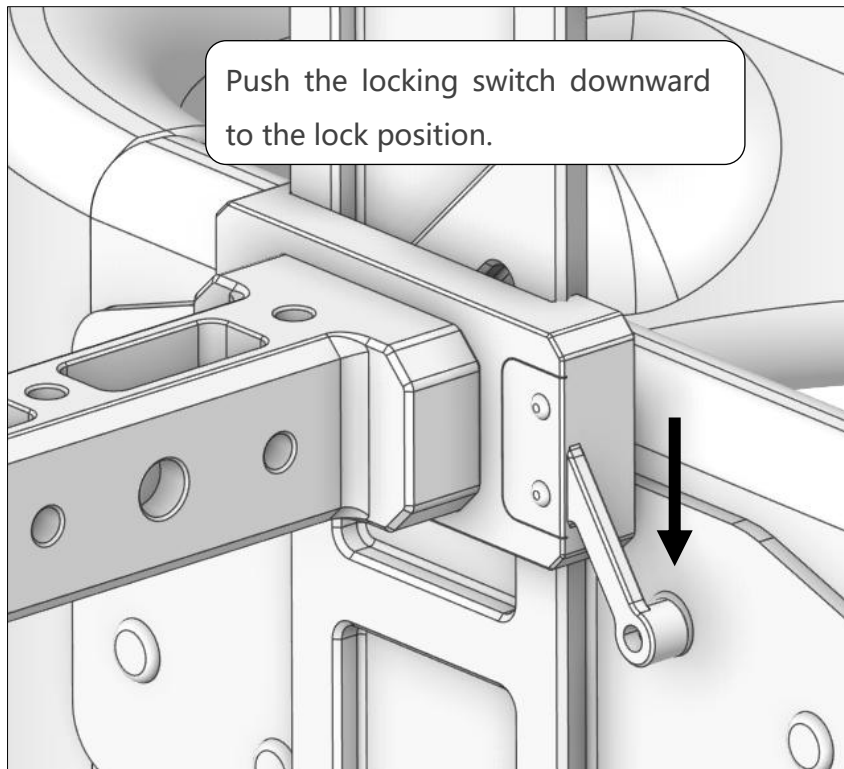
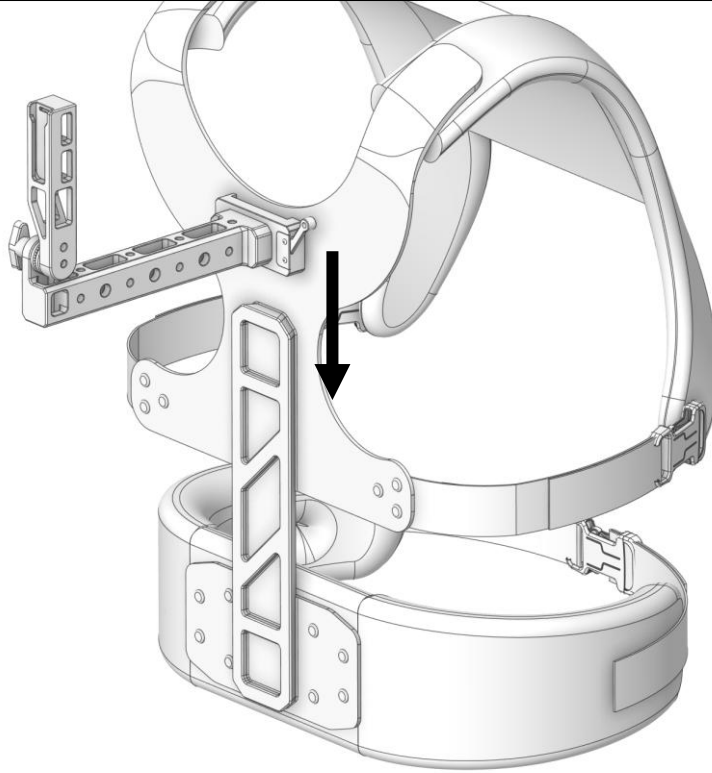

3

Align the slide rail of the SLAM device mount with the groove of the chest support arm, insert it downward until the anti-drop latch on the SLAM device mount fully pops out to secure the SLAM scanner.

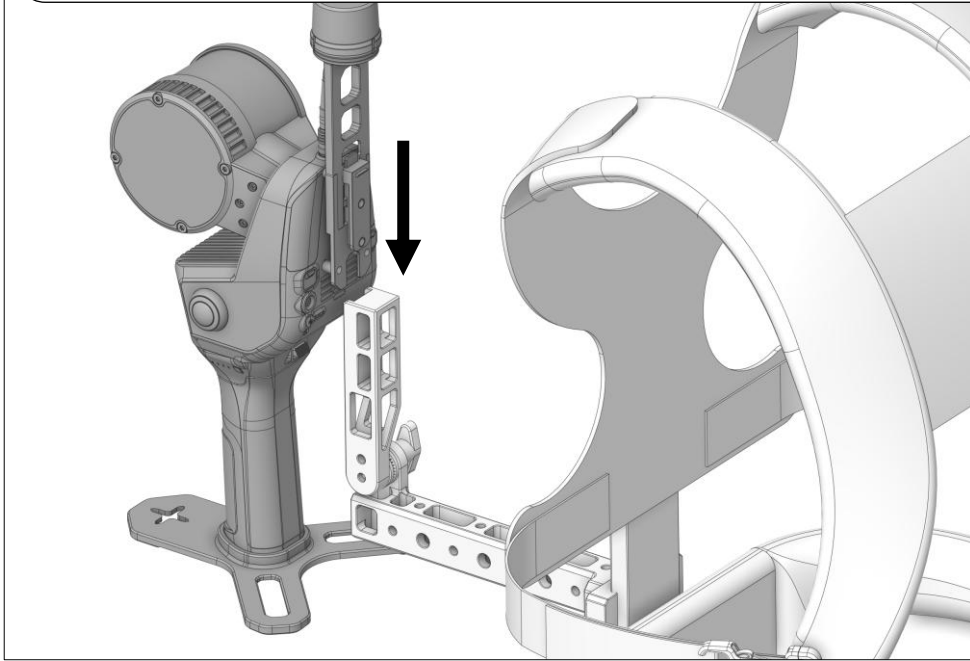

4

Adjust the pitch angle of the scanner as needed for the scene, then tighten the fixing screw on the vertical support arm.

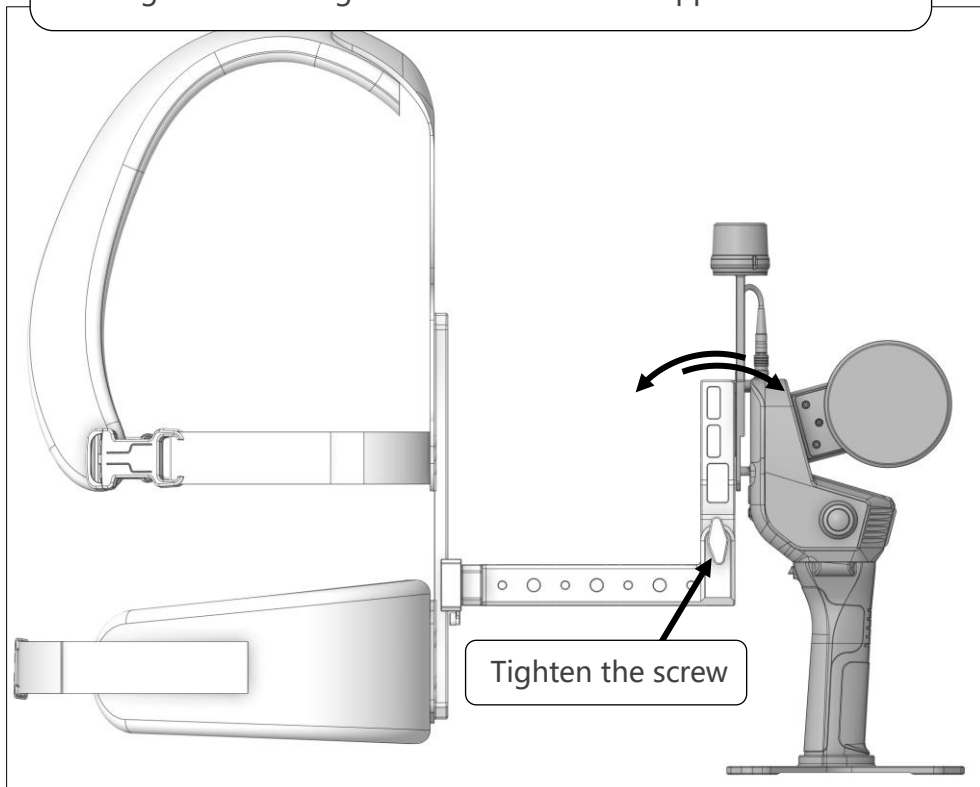

5

The horizontal support arm of the S-AS200 is equipped with a reserved 1/4-inch threaded mounting hole to support the installation of a phone or tablet holder.

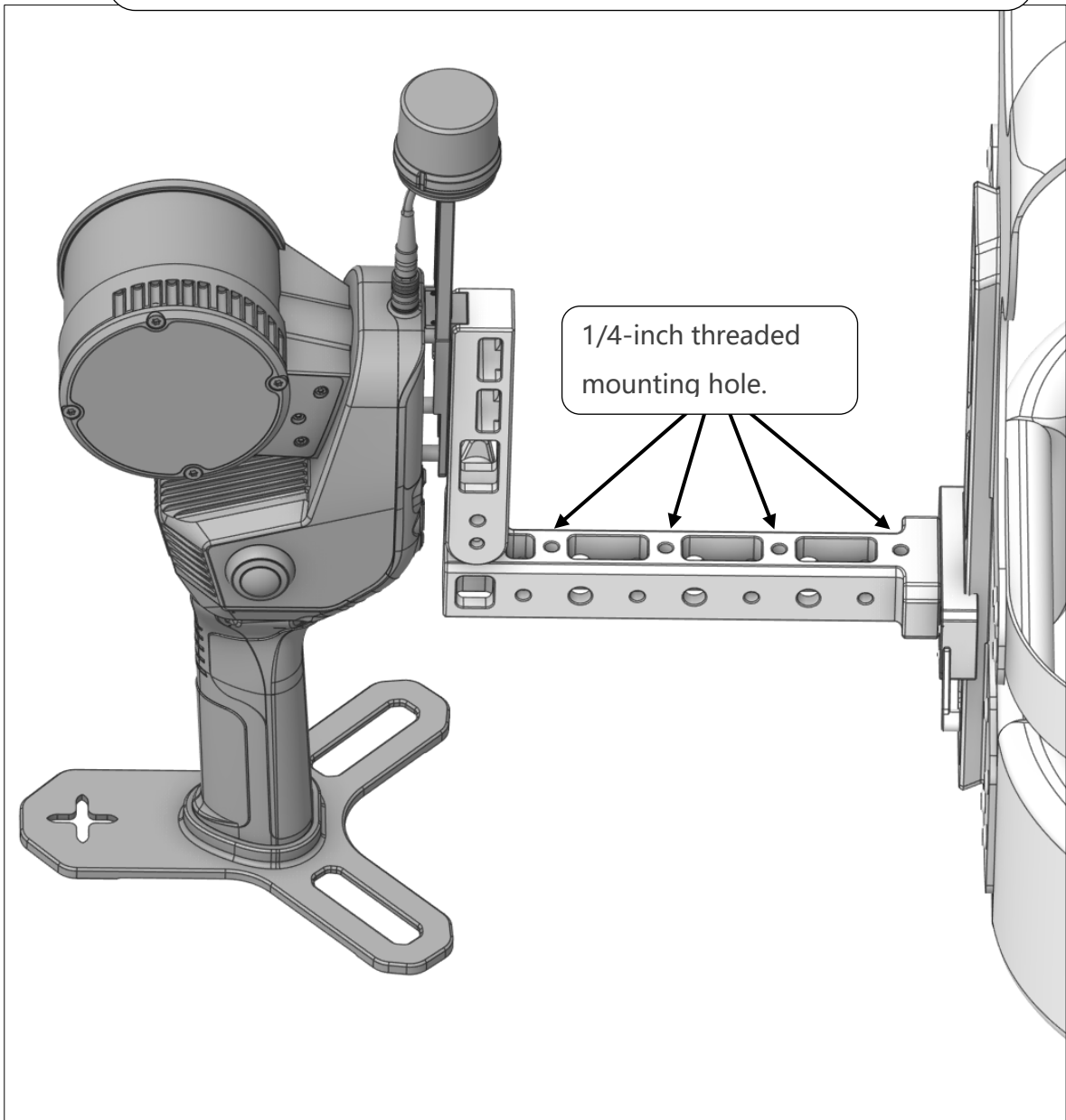

6

Users should adjust the tightness of the waist and chest straps according to their own condition after wearing to achieve a comfortable fit.

Wearing Demonstration



※ This product kit does not include a phone or tablet holder. Contact with Feima Robotics for more information about the optional phone or tablet holder.

Contact Us



If you have any questions or suggestions regarding this manual, please contact us via email.

: aftersales@feimarobotics.com

www.feimarobotics.com