

DMT200

Adapter Bracket
Product Manual
202507

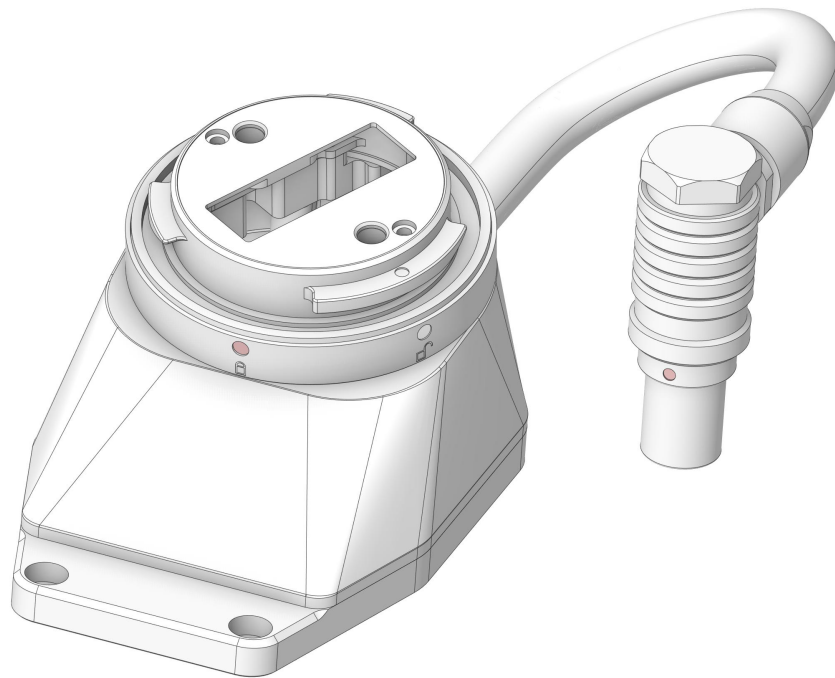

Shenzhen Feima Robotics Co., Ltd.

Disclaimer

Thank you for choosing FEIMA products. The content mentioned in this document pertains to your safety and legal rights and responsibilities. Before using this product, please read this document carefully to ensure correct setup. Failure to follow and adhere to the instructions and warnings in this document may damage the DMT200 or other surrounding items. This document and all related documents for the DMT200 are subject to the final interpretation of Shenzhen Feima Robotics Co., Ltd. (hereinafter referred to as "Feima Robotics"). In case of updates, no separate notice will be given.

By using this product, you acknowledge that you have read the disclaimer and warnings carefully, understood, recognized, and accepted all terms and contents of this statement. You commit to taking full responsibility for using this product and any consequences thereof. You agree to use this product solely for legitimate purposes and comply with these terms as well as any relevant regulations, policies, and guidelines established by Feima Robotics. Except as provided by current laws and regulations of China, Feima Robotics does not assume responsibility for any losses, injuries, or liabilities directly or indirectly caused by the use of the product or this material. Users should follow all safety instructions mentioned herein. Feima Robotics reserves the right to change this product manual and product status. For the latest version of the product manual, please visit www.feimarobotics.com.



This trademark belongs to Shenzhen Feima Robotics Co., Ltd. and its affiliated companies. Product names, brands, etc., appearing in this document are trademarks or registered

trademarks of their respective companies.

DMT200 is a precision device. Users should possess basic manual skills and safety knowledge and handle it with care. Uncertain operations can lead to product damage and property loss. This product is not suitable for children. Do not use non-Feima Robotics products or operate without following Feima Robotics' safety guidelines. This document contains safety instructions, operation, and maintenance descriptions. To ensure correct and safe use of the DMT200, please read the product manual and safety instructions carefully before installation, setup, and use, and strictly follow the relevant instructions.

Tips Introduction:

Tip: ——Important content for special reminder.

Notice! ——Important content that may cause equipment damage if operated incorrectly.

⚠ Warning — — Important content that may cause equipment damage or even personal injury if operated incorrectly.

Notice!

- **The DMT200 is a high-precision device. Dropping it or subjecting it to external force collisions may damage the DMT200 and cause abnormal operation.**
- **Please pay attention to dust and sand prevention when using the DMT200.**
- **Do not place the device in a location with direct sunlight, poor ventilation, or near heat sources such as heaters.**
- **Please ensure that the device connection port is dry and free of water before connecting and installing.**
- **Do not hot - plug the DMT200 while it is powered on. If you need to power off, please turn off the power through the power button of the aircraft.**
- **The DMT200 is a precision device. Please place it in a safety box during turnover and transportation.**

Catalog

Product Overview	5
Introduction	5
Specifications	5
Installation and Usage	6
Installation on Drone (Example: DJI M300)	6
Remove DMT200	12
The DMT200 is precisely engineered, so whether installing or removing it, please handle it with care.	15
Filed Work	15
Maintenance and Storage	20
Device Cleaning	20
Storage Requirements	20
Transportation	20
Contact us	21

Product Overview

Introduction

The DMT200 is an adapter bracket designed for mounting the SLAM200 laser scanner on DJI interface drones.

Specifications

Model	DMT200
Interface Type	DJI payload Interface
Dimensions	L x W x H 77mm×47mm×38mm
Weight	120g (±5g)
Color	Black
Material	Aerospace Aluminum Alloy
Operating Temperature	-20°C~+50°C
Storage Temperature	-40°C~+70°C

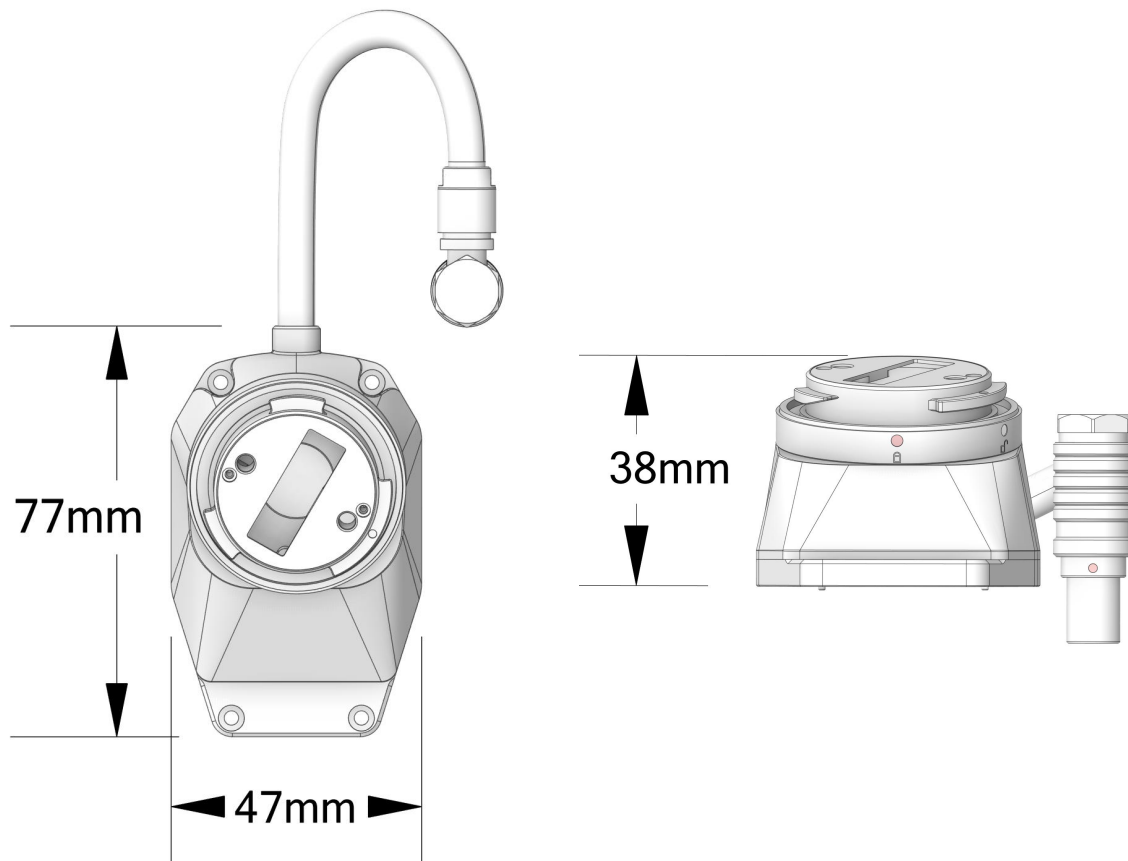

Installation and Usage

Installation on Drone (Example: DJI M300)

1

Remove the battery handle from the SLAM200 laser scanner (SLAM200 will be powered by the flight platform). Align the holes of the DMT200 with the installation holes of the SLAM200.

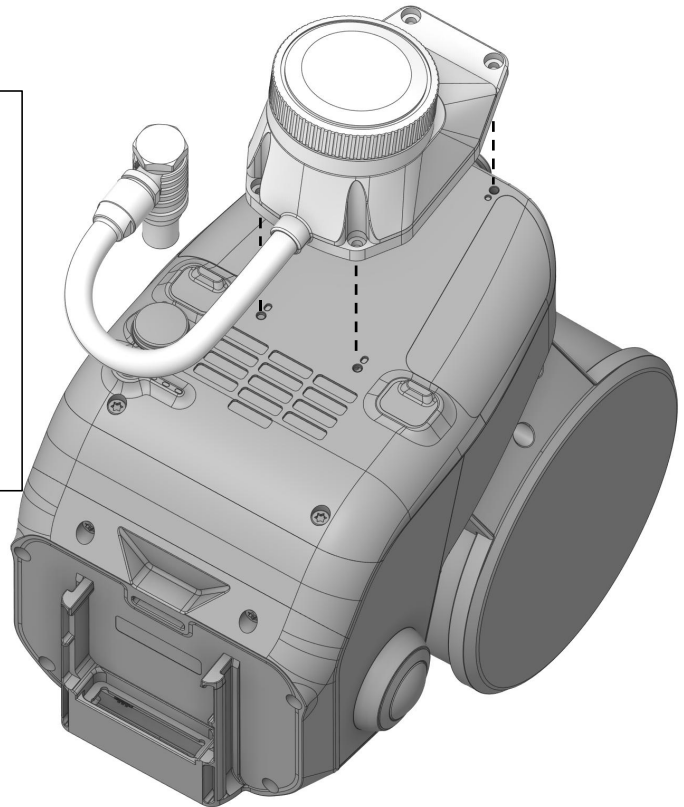

2

Securely fasten the DMT200 to the SLAM200 using the four screws provided.

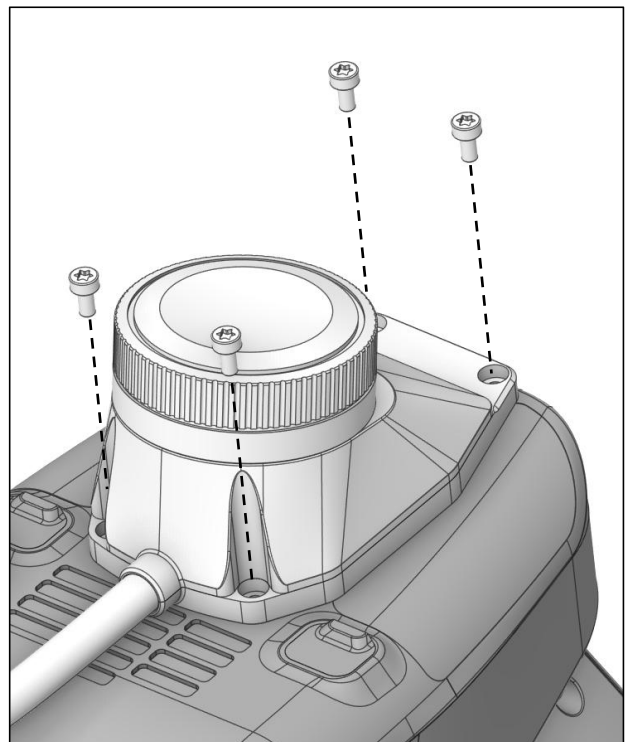

- 3 Confirm the SLAM200 body's aviation plug port (interaction interface) and remove the dust cap above the port. Insert the aviation plug cable of the DMT200 into the aviation plug port of the SLAM200. Note the anti-reverse design and red markings on both the plug and the port.

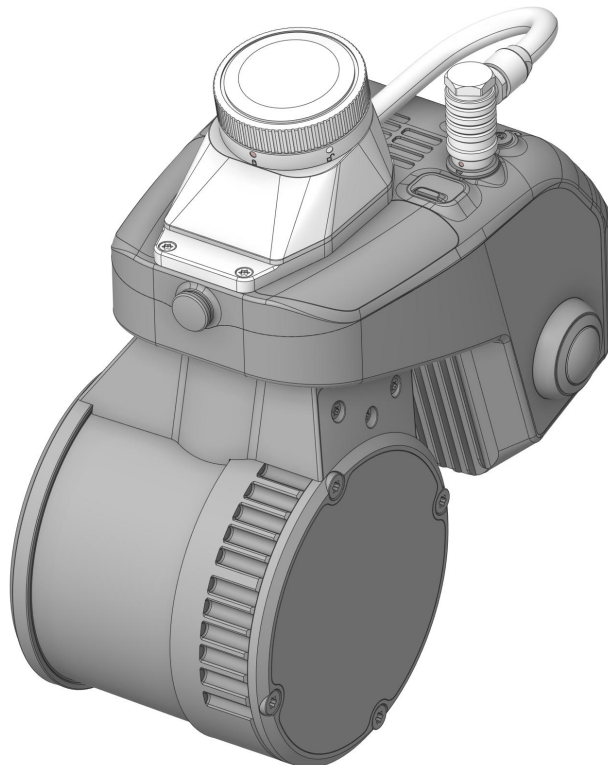
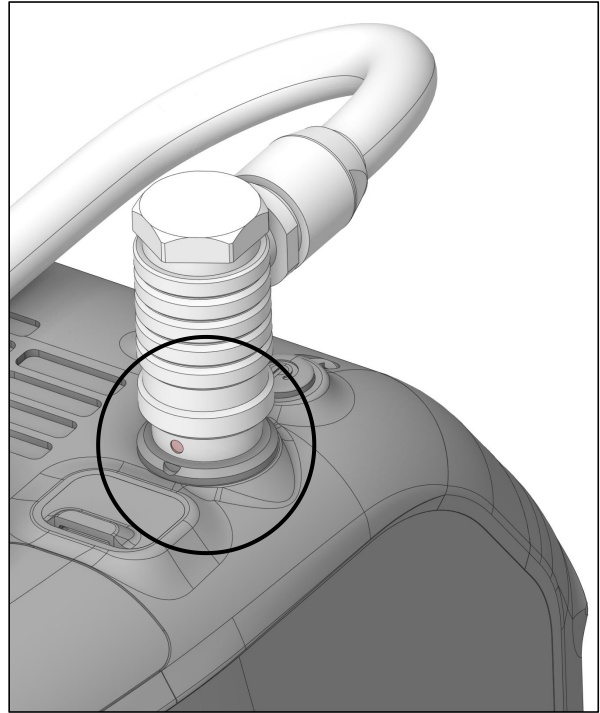
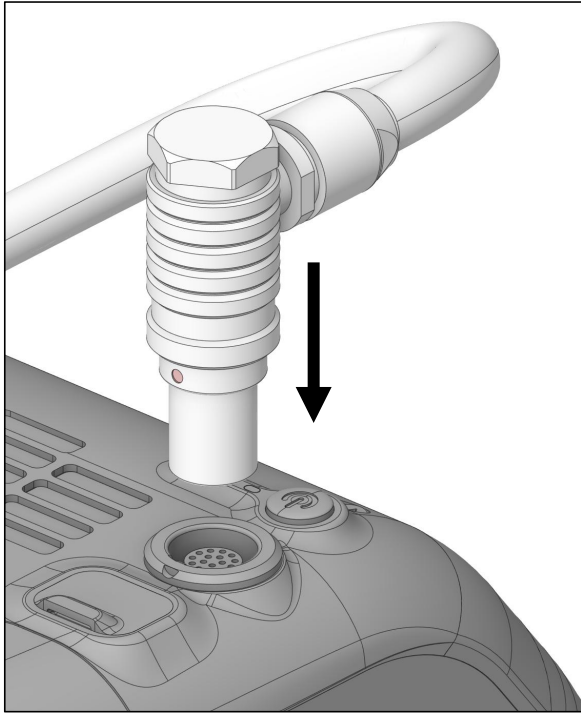

- 4 Unscrew and remove the interface dust cover of the DMT200.

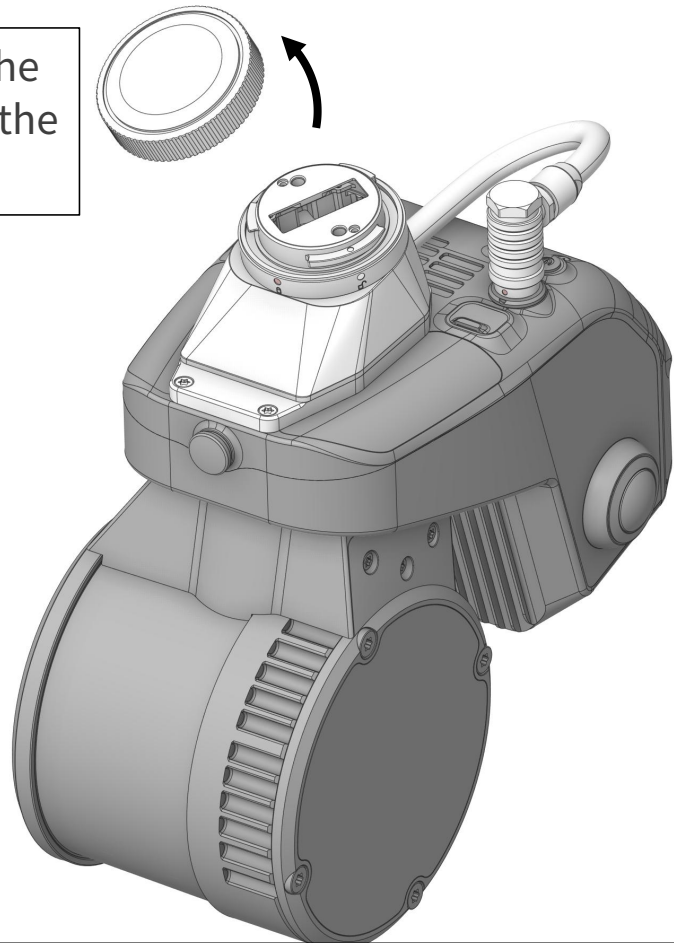

- 5 Ensure the "unlock" position icon of the DMT200 interface aligns with the red dot on the airborne mount before gently inserting the DMT200 interface into the airborne mount.

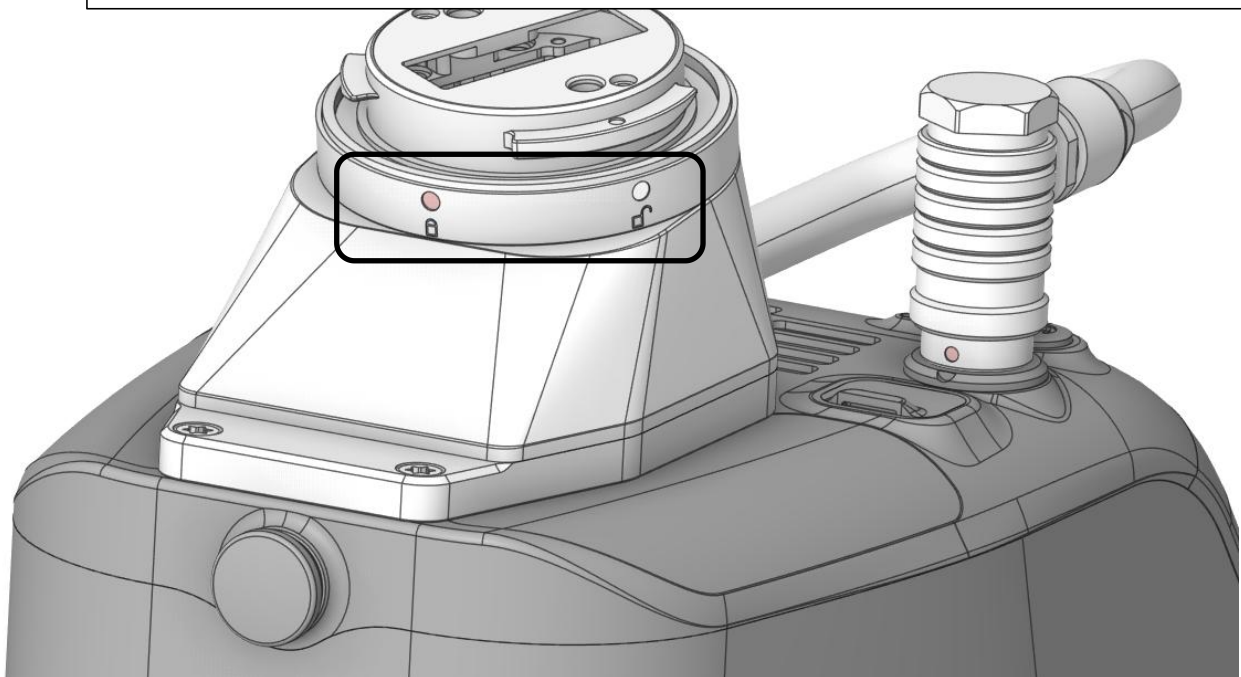

- 6 As shown in the figure, first confirm that the "unlock" position of the DMT200 interface is aligned with the red dot on the airborne pylon, and then gently push the DMT200 interface into the airborne pylon.

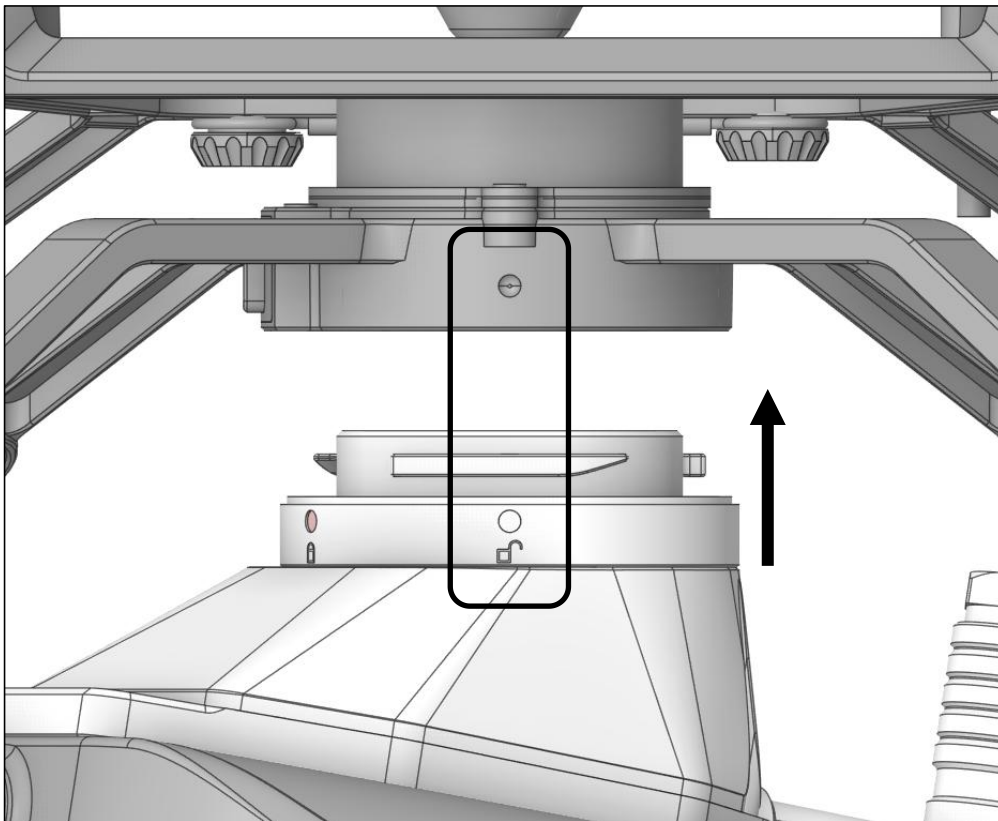
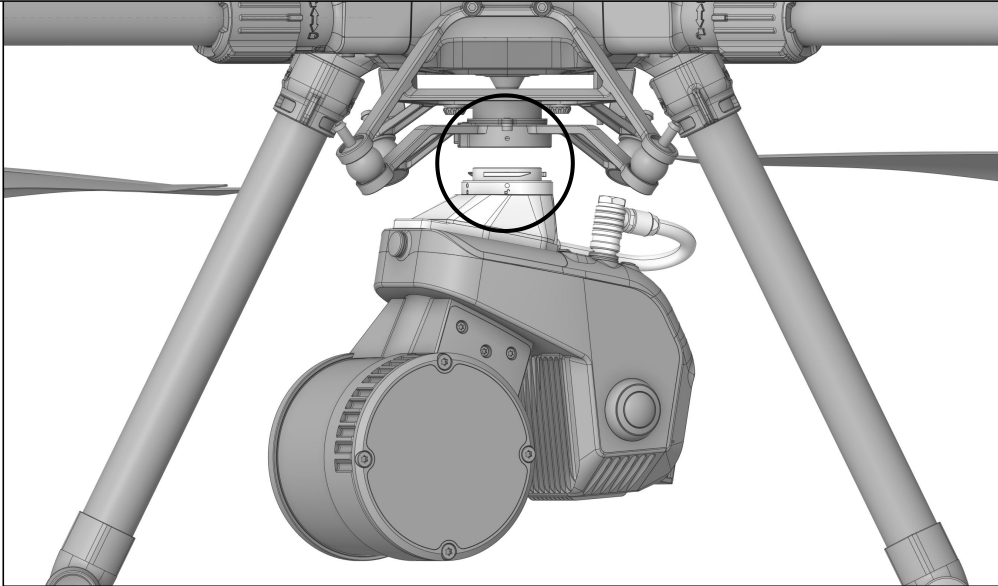

7

Rotate the payload counterclockwise until it locks into place (red dots aligned), and you hear a "click." Check that the release button of the drone interface has returned to its original position and the payload is secure.

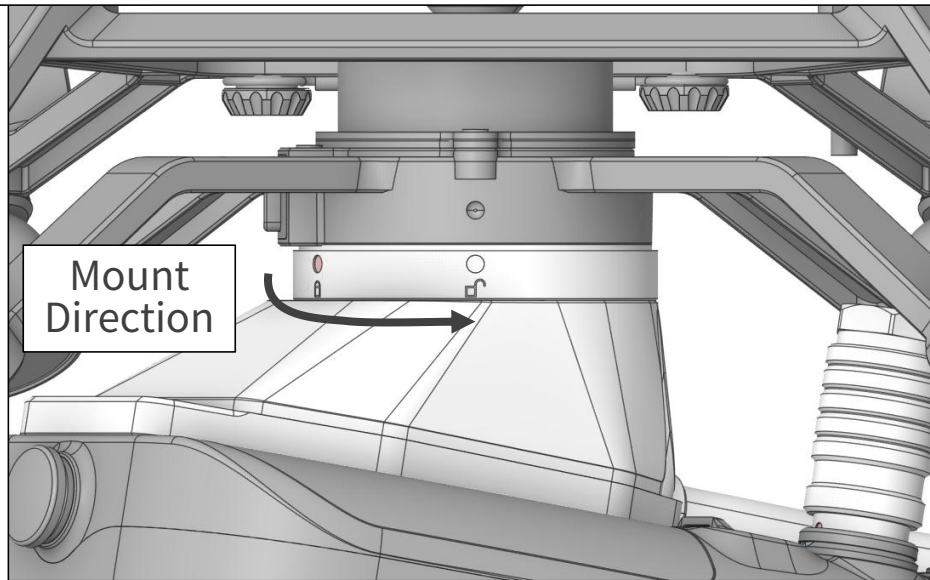

Align the two red marked points to the "locked" position.

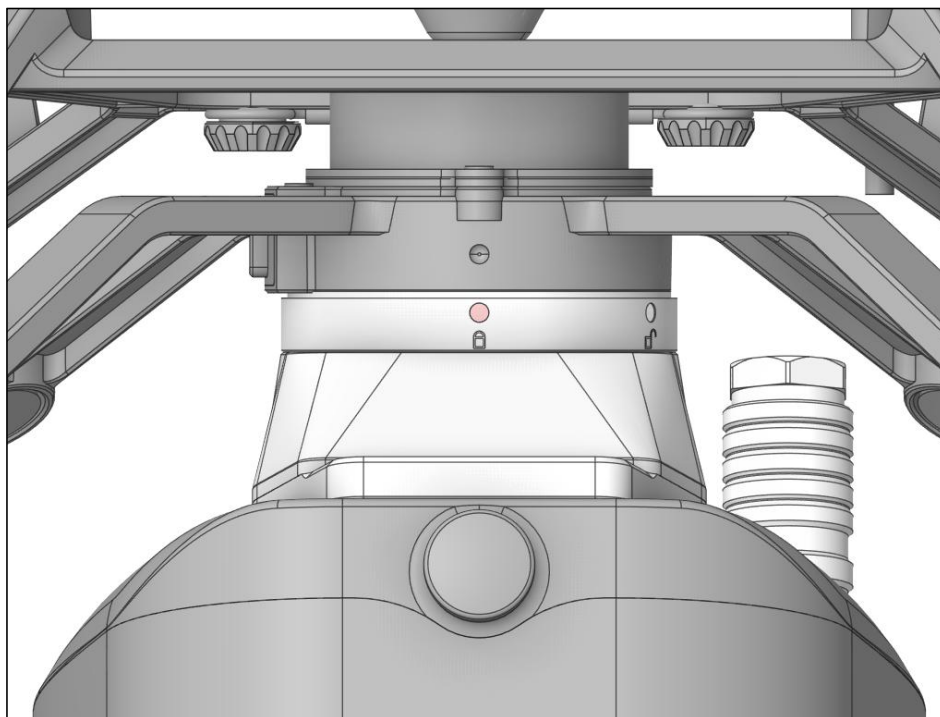

Schematic diagram of installation completion

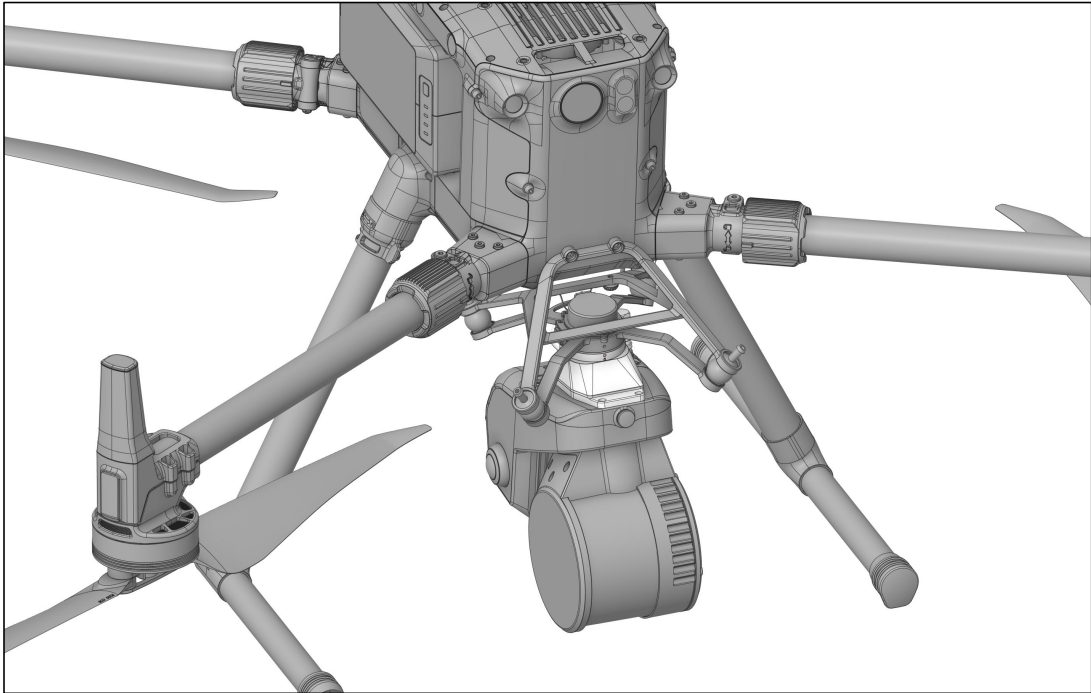

Front View

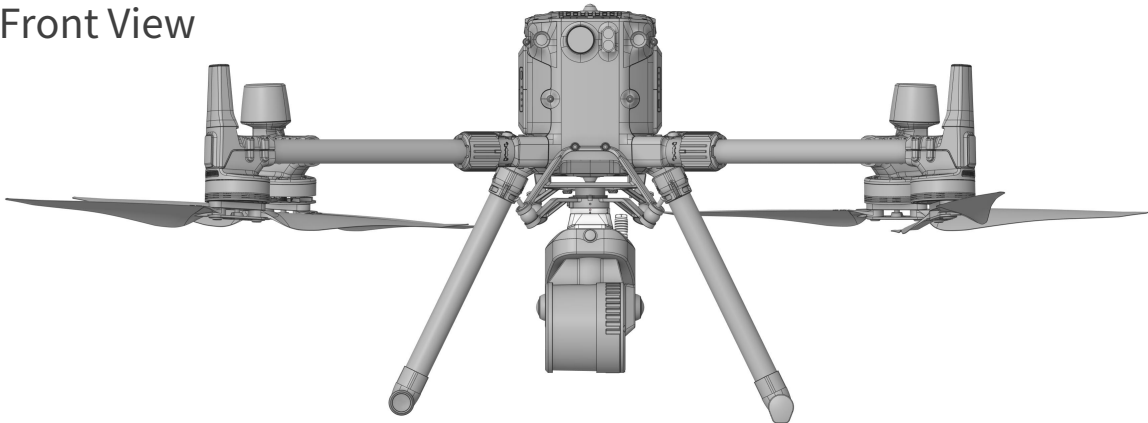

Right View

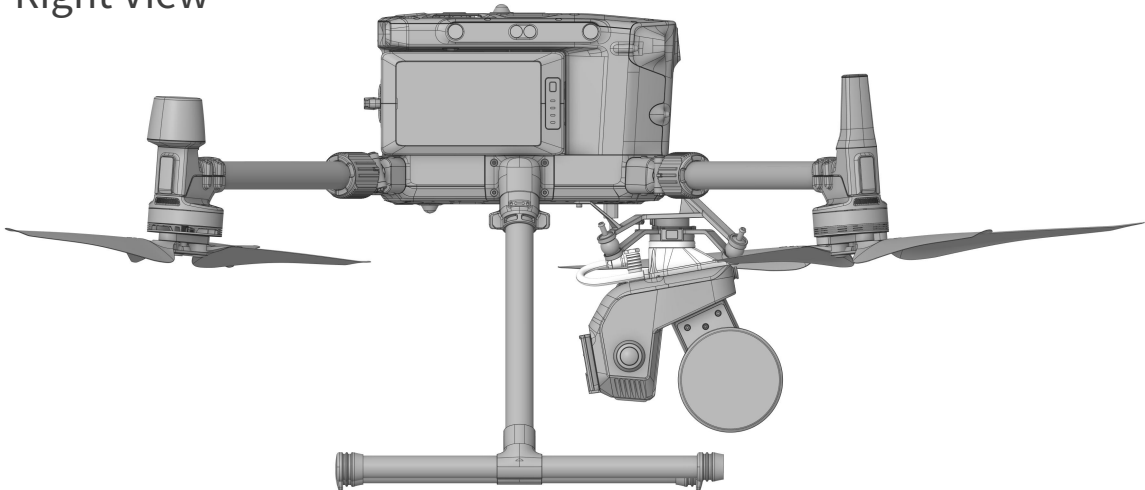

Remove DMT200

① If you need to remove the DMT200 from the flight platform, please turn off the power of the aircraft first.

Press and hold the payload release button on the airborne pylon while turning the payload clockwise. When the marking position is turned to the unlocking position (white dot), you can gently take out the payload

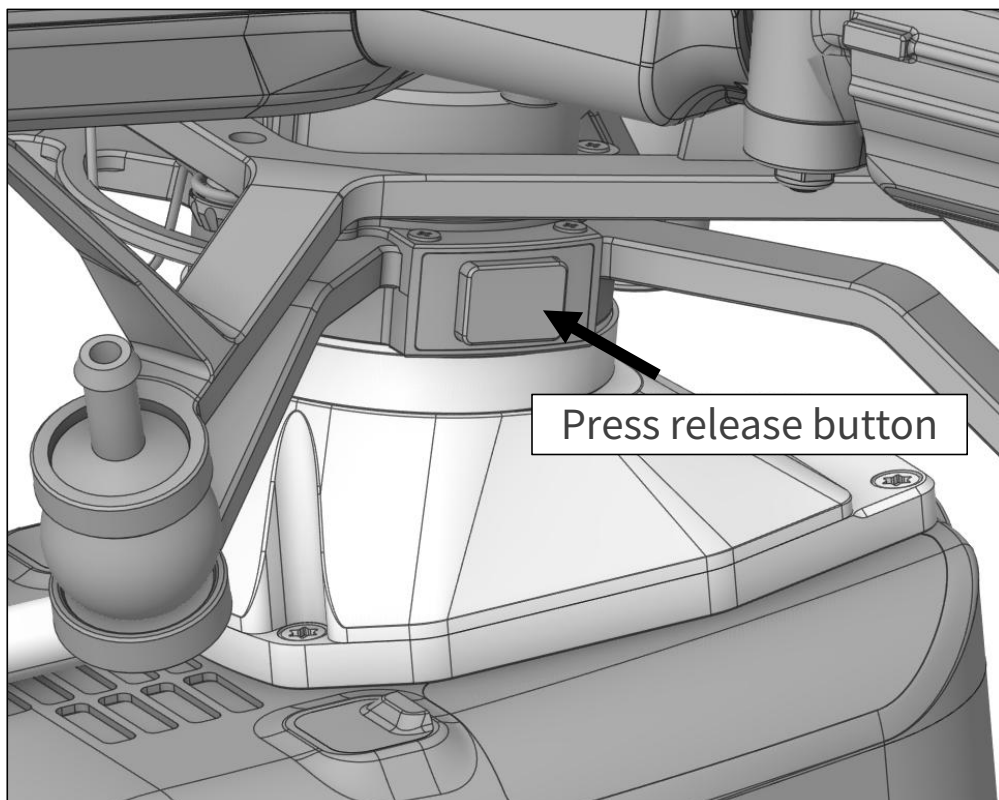
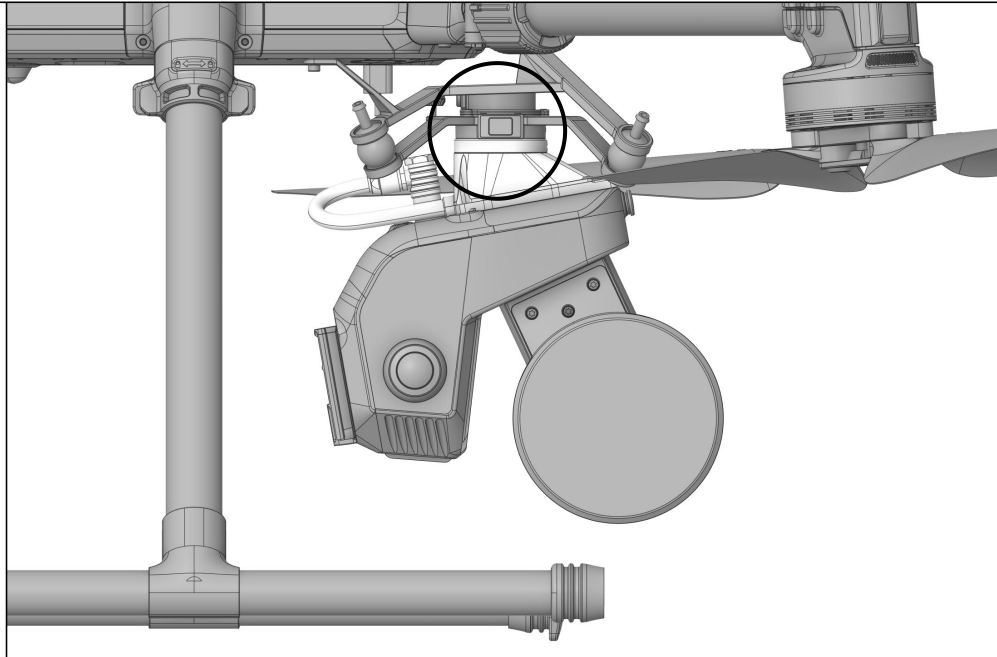

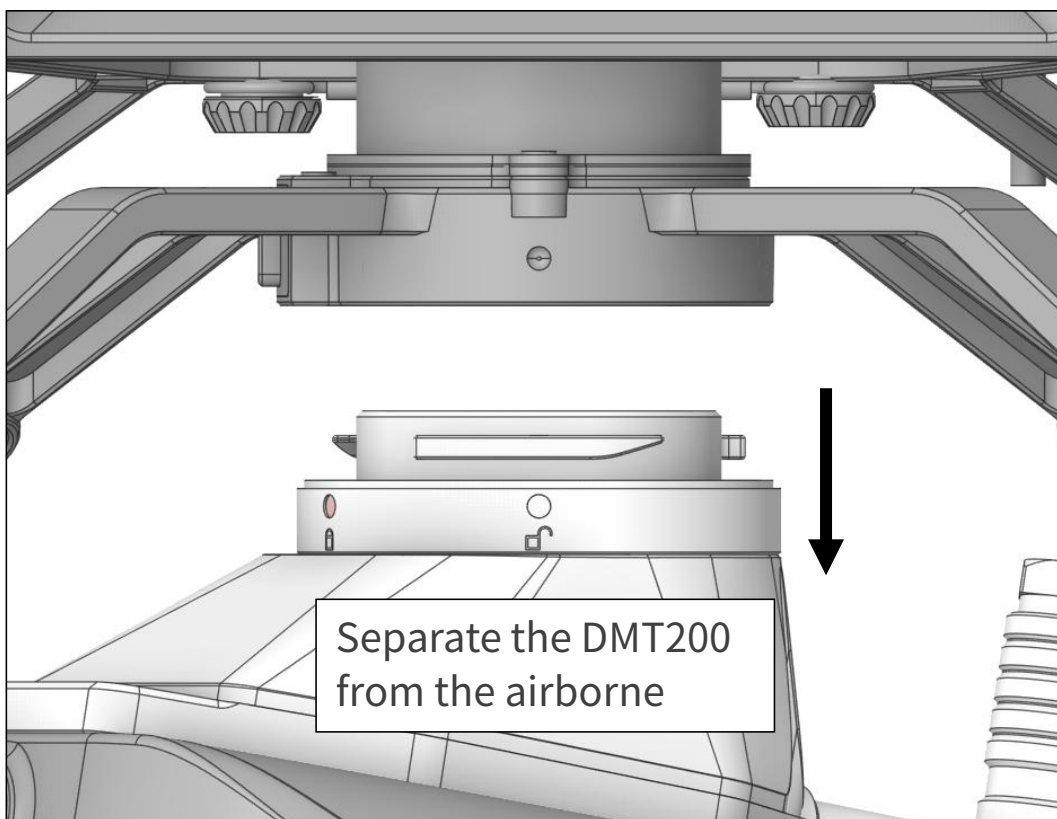
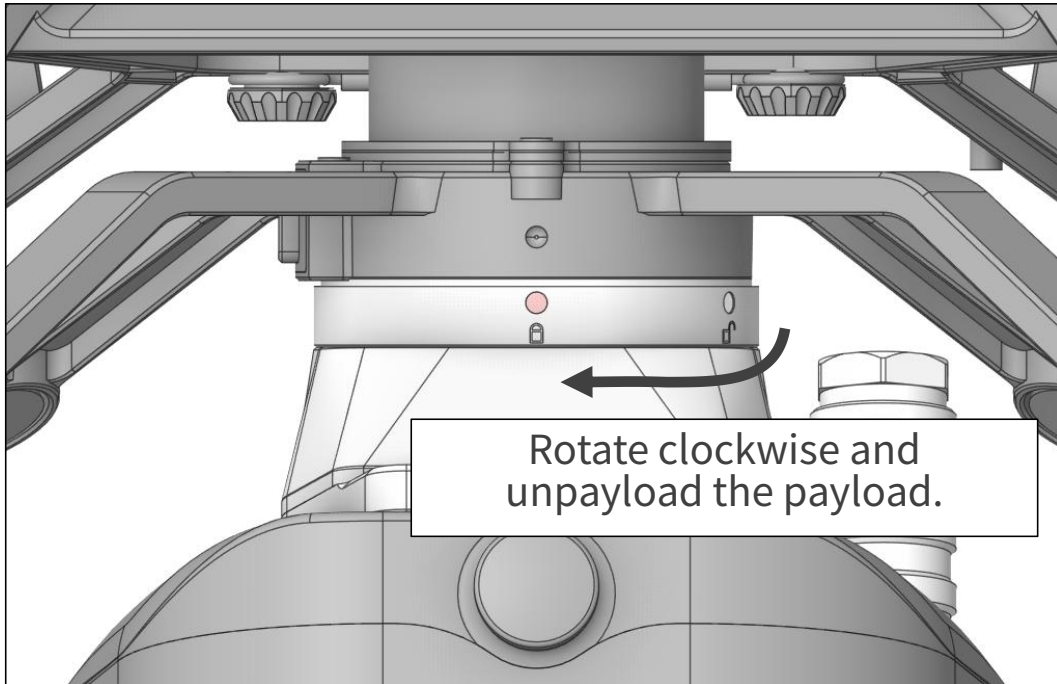

Notice!

- Please be sure to carefully lift the payload when removing it to prevent the radar head from hitting the ground and causing damage to the device.

- 2 Cover the DMT200 interface with the dust cap, rotate it clockwise, and tighten it.

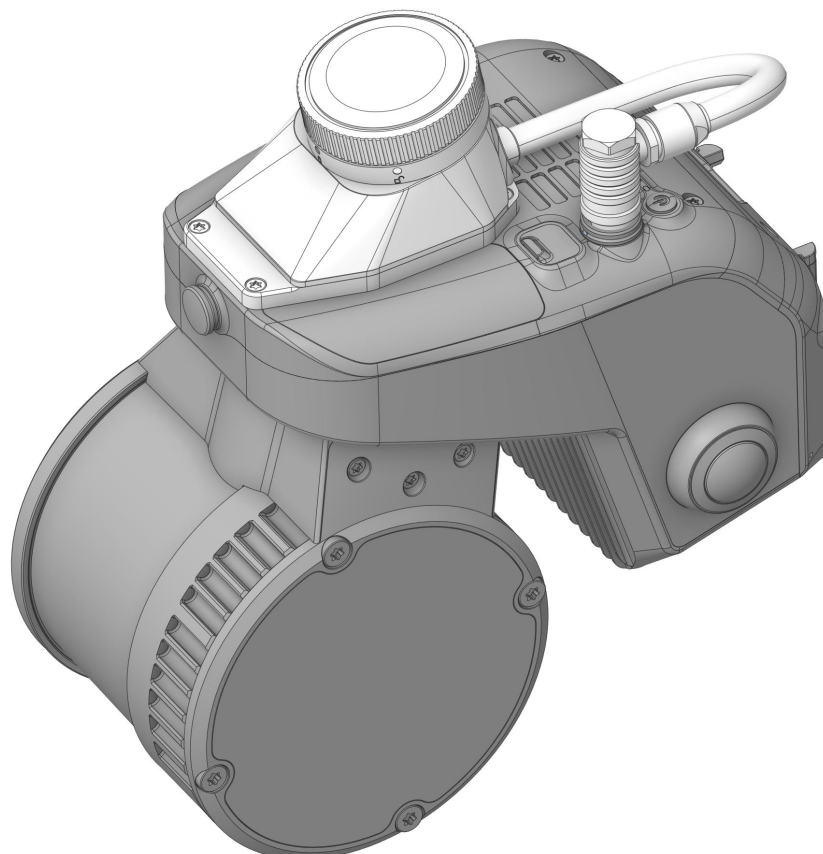
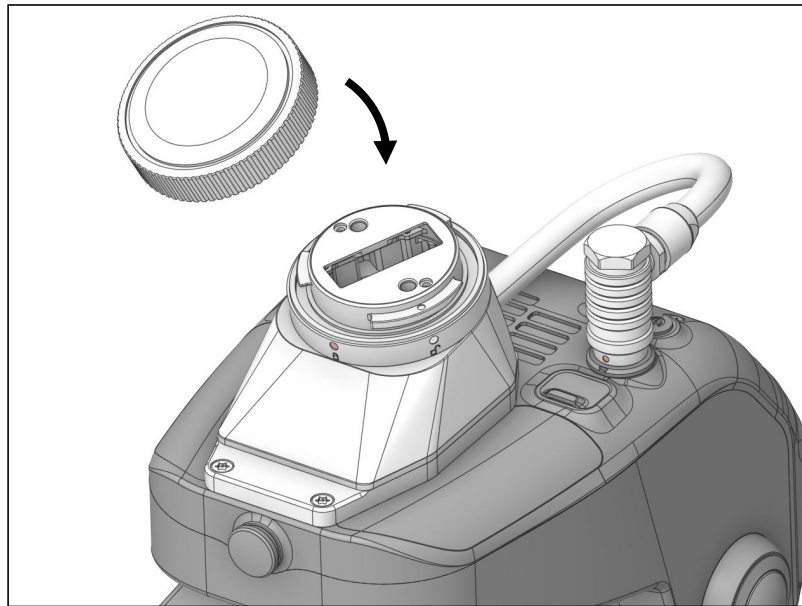

Notice!

The DMT200 is precisely engineered, so whether installing or removing it, please handle it with care.

Filed Work

1. After the payload is installed, short press and then long press the power button on the M300 to power on the aircraft. Wait for the drone to acquire satellite signals and complete positioning.
2. Turn on the DJI remote controller, tap to enter the "Flight Route" interface, and plan the required route. A recommended flight altitude is below 120 meters, with a route spacing of 50 meters and a flight speed of 8 meters per second.
3. Ensure the remote controller is properly connected to the internet (via SIM card or WiFi). Tap the three dots in the top right corner → Tap the satellite icon → Under RTK service type, select "Custom Network RTK" → Enter the correct differential network account information → Confirm that the RTK status appears as green text "Connected" . After closing the menu, "RTK" and the number of satellites will be displayed at the top of the screen.
4. Power on the SAM200.
5. Short press the SLAM200 power button. When the status indicator light changes to slow flashing green, the device will begin initialization — the LiDAR head will slowly rotate five times. Once initialization is complete, it will return to normal rotation speed and begin collecting data, and you may proceed to take off.

Tips:

- After mounting the SLAM200, make sure there are no obstacles within the rotation radius of the LiDAR head that could hinder its movement.
- When the SLAM200 begins data acquisition, personnel should stay clear of the device or move to the rear of the aircraft to avoid interfering with normal data collection.

6. Upload the flight route and start executing the mission.

飞前检查 ×

一切正常 健康管理 >

N挡 97% 50.4V 97% 50.3V 60% -- A控

H 已设置 RTK 已连接 128.0G

返航高度 (20~1500m)	-100 -10 150 +10 +100	失联行为	返航 ▼
限高 (20~1500m)	-100 -10 500 +10 +100	限远	<input type="checkbox"/>
返航点	📍 👤 A	摇杆模式	美国手 ▼

自定义电量报警 严重低电量: 10% 低电量: 15%

避障行为 刹停 关闭

水平避障	A	刹停: 3.1m 告警: 40.0m	<input type="range"/>
上避障	A	刹停: 3.0m 告警: 30.0m	<input type="range"/>
下避障	A	刹停: 3.0m 告警: 30.0m	<input type="range"/>

下一步

建图航拍检查单 ✕

🔋 97% 50.3V
🔋 97% 50.3V
RTK 已连接
🔋 60%
🔋 --
💾 128.00 G

2412 m 航线长度	5 m 26 s 预计时间	14 航点	20.00 cm/pixel 建图GSD	69张 负载1照片
-----------------------	-------------------------	-----------------	--------------------------------	---------------------

安全起飞高度

-100
-10
20
+10
+100

照片存储 - OTHER

航线完成动作

自动返航
▼

航线失联行为

自动返航
▼

上一步

上传航线

建图航拍检查单 ✕

🔋 85% 47.8V
🔋 85% 47.8V
RTK 已连接
🔋 57%
🔋 --
💾 128.00 G

2412 m 航线长度	5 m 26 s 预计时间	14 航点	20.00 cm/pixel 建图GSD	69张 负载1照片
-----------------------	-------------------------	-----------------	--------------------------------	---------------------

安全起飞高度

-100
-10
20
+10
+100

照片存储 - OTHER

航线完成动作

自动返航
▼

航线失联行为

自动返航
▼

开始执行

7. During the operation, ensure that the remote controller remains properly connected to the aircraft at all times, and that the RTK icon stays active (illuminated).

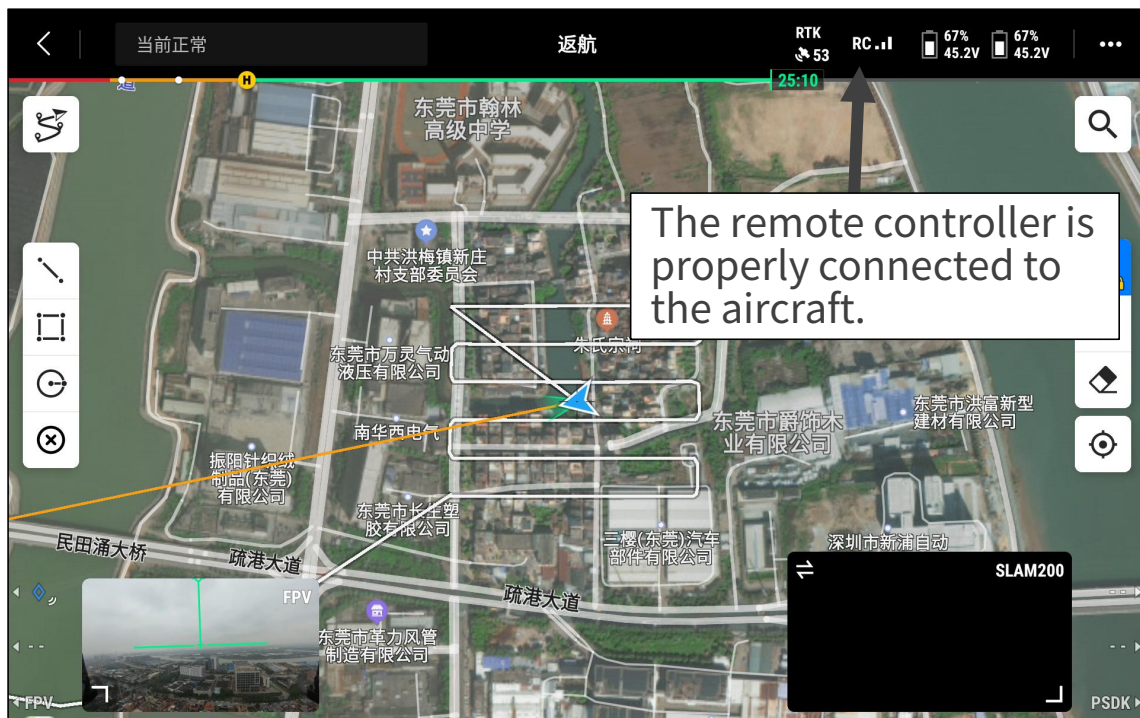

8. After the aircraft lands, short press the SLAM200 power button. The LiDAR head will stop rotating, and data acquisition will end. The indicator light will change to fast-flashing green, indicating that the SLAM200 is saving data. Once data saving is complete, the light will turn solid green.
9. Power off the aircraft and remove the payload to copy the data.

Tips:

- Please fly above clearly distinguishable ground features; otherwise, calculation failures may occur.

- **Please end the current LiDAR data acquisition after the aircraft lands. Once the SLAM200's green indicator light turns solid, you may proceed with the next scanning operation.**

Maintenance and Storage

Device Cleaning

During takeoff and landing, the propellers may stir up dust from the ground. After a day of flying, dust may accumulate on the DMT200 casing. To ensure reliable device performance, it is recommended to clean the DMT200 casing and interface areas with an air blower or soft brush after each use.

Storage Requirements

Store the DMT200 in a dry, well-ventilated area at room temperature. Avoid environments with high humidity to prevent condensation inside the device. The recommended storage environment is a relative humidity of less than 40% and a temperature of $+20 \pm 5^{\circ}\text{C}$.

Transportation

As a precision device, the DMT200 should be removed from the aircraft and placed in a protective case during transportation to avoid surface damage or connector malfunctions.

※ This manual is subject to updates without prior notice.

Contact us



If you have any questions or suggestions regarding this manual, please contact us via email: aftersales@feimarobotics.com

www.feimarobotics.com